

## Single Pack FR6DL 220-240V 50Hz CSIR

Single pack code number: **195B4040**

| Position | Title                                      | Code     | Amount |
|----------|--|----------|--------|
| 1        | Compressor FR6DL                           | 103U2680 | 1      |
| 2        | Starting relay                             | 117U6010 | 1      |
| 3        | Starting capacitor (80µF 220V, 6.3mm)      | 117U5015 | 1      |
| 4        | Cord relief                                | 103N1010 | 1      |
| 5        | Cover                                      | 103N2010 | 1      |
| 6        | Bolt joint for one compressor   M6   ø16mm | 118-1917 | 1      |

**Secop GmbH** • Lise-Meitner-Straße 29 • 24941 Flensburg, Germany • Tel: +49 461 4941 0 • [www.secop.com](http://www.secop.com)

Secop accepts no responsibility for possible errors in catalogs, brochures, and other printed material. Secop reserves the right to alter its products without notice. This also applies to products already on order provided that such alterations can be made without subsequent changes being necessary to specifications already agreed. All trademarks in this material are the property of the respective companies. Secop and the Secop logotype are trademarks of Secop GmbH. All rights reserved.

**FR6DL**  
**MBP/HBP Compressor**  
**R404A/R507**  
**220-240V 50Hz**

## General

|                       |               |
|-----------------------|---------------|
| Code number           | 103U2680      |
| Approvals             | EN 60335-2-34 |
| Compressors on pallet | 80            |

## Application

| Application                                    |    | MBP/HBP   |    |
|--|----|-----------|----|
| Frequency                                      | Hz | 50        | 60 |
| Evaporating temperature                        | °C | -20 to 15 | —  |
| Voltage range                                  | V  | 198 - 254 | —  |
| Max. condensing temperature continuous (short) | °C | 50 (60)   | —  |
| Max. winding temperature continuous (short)    | °C | 125 (135) | —  |

### Cooling requirements

| Cooling requirements    |    |     |                |                |     |     |     |
|-------------------------|----|-----|----------------|----------------|-----|-----|-----|
| Frequency               | Hz | 50  |                |                | 60  |     |     |
| Application             |    | LBP | MBP            | HBP            | LBP | MBP | HBP |
| 32°C                    |    | –   | F <sub>2</sub> | F <sub>2</sub> | –   | –   | –   |
| 38°C                    |    | –   | F <sub>2</sub> | F <sub>2</sub> | –   | –   | –   |
| 43°C                    |    | –   | –              | –              | –   | –   | –   |
| Remarks on application: |    |     |                |                |     |     |     |

## Motor

| Motor type                                | CSIR |      |      |
|---|------|------|------|
| LRA (rated after 4 sec. UL984), HST   LST | A    | 10.0 | –    |
| Cut in Current, HST   LST                 | A    | 10.0 | –    |
| Resistance, main   start winding (25°C)   | Ω    | 7.3  | 12.0 |

## Design

|                                     |                 |                   |
|-------------------------------------|-----------------|-------------------|
| Displacement                        | cm <sup>3</sup> | 6.23              |
| Oil quantity (type)                 | cm <sup>3</sup> | 450 (polyolester) |
| Maximum refrigerant charge          | g               | 850               |
| Free gas volume in compressor       | cm <sup>3</sup> | 1350              |
| Weight without electrical equipment | kg              | 10.5              |

## Dimensions

| Dimensions           |                          | mm                       |           |
|----------------------|--------------------------|--------------------------|-----------|
| Height               |                          | A                        | 196       |
|                      |                          | B                        | 191       |
|                      |                          | B1                       | –         |
|                      |                          | B2                       | –         |
| Suction connector    | location/I.D. mm   angle | C                        | 8.2   30° |
|                      | material   comment       | Cu-plated steel   Al cap |           |
| Process connector    | location/I.D. mm   angle | D                        | 6.2   30° |
|                      | material   comment       | Cu-plated steel   Al cap |           |
| Discharge connector  | location/I.D. mm   angle | E                        | 6.2   25° |
|                      | material   comment       | Cu-plated steel   Al cap |           |
| Oil cooler connector | location/I.D. mm   angle | F                        | –         |
|                      | material   comment       | –                        |           |
| Connector tolerance  | I.D. mm                  | ±0.09                    |           |
| Remarks:             |                          |                          |           |

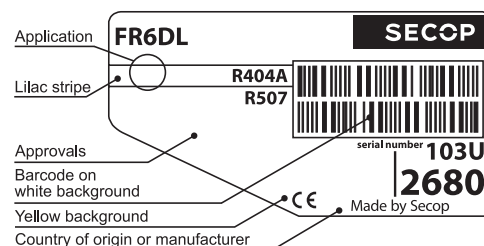

S = Static cooling normally sufficient  
O = Oil cooling  
F<sub>1</sub> = Fan cooling 1.5 m/s  
(compressor compartment temperature  
equal to ambient temperature)  
F<sub>2</sub> = Fan cooling 3.0 m/s necessary  
SG = Suction gas cooling normally sufficient  
– = not applicable in this area

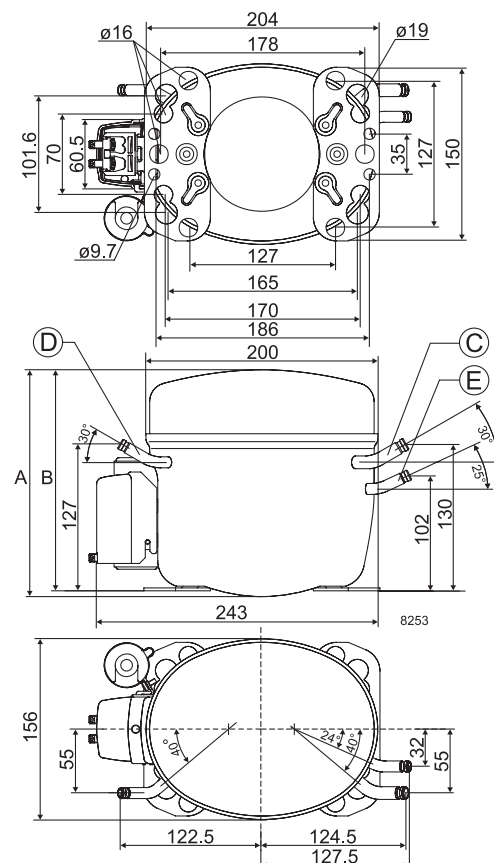

**EN 12900 Household (CECOMAF)**220V, 50Hz, fan cooling F<sub>2</sub>

|                    |     |     |     |     |     |       |      |      |      |      |      |      |      |      |      |      |    |
|--------------------|-----|-----|-----|-----|-----|-------|------|------|------|------|------|------|------|------|------|------|----|
| Evap. temp. in °C  | -45 | -40 | -35 | -30 | -25 | -23.3 | -20  | -15  | -10  | -6.7 | -5   | 0    | 5    | 7.2  | 10   | 15   | 20 |
| Capacity in W      |     |     |     |     |     |       | 317  | 385  | 471  | 538  | 576  | 698  | 840  | 907  | 999  | 1177 |    |
| Power cons. in W   |     |     |     |     |     |       | 290  | 321  | 354  | 377  | 388  | 423  | 456  | 469  | 485  | 509  |    |
| Current cons. in A |     |     |     |     |     |       | 1.91 | 1.99 | 2.10 | 2.19 | 2.23 | 2.37 | 2.51 | 2.56 | 2.62 | 2.70 |    |
| COP in W/W         |     |     |     |     |     |       | 1.09 | 1.20 | 1.33 | 1.43 | 1.48 | 1.65 | 1.84 | 1.93 | 2.06 | 2.31 |    |

**ASHRAE LBP\***220V, 50Hz, fan cooling F<sub>2</sub>

|                    |     |     |     |     |     |       |      |      |      |      |      |      |      |      |      |      |    |
|--------------------|-----|-----|-----|-----|-----|-------|------|------|------|------|------|------|------|------|------|------|----|
| Evap. temp. in °C  | -45 | -40 | -35 | -30 | -25 | -23.3 | -20  | -15  | -10  | -6.7 | -5   | 0    | 5    | 7.2  | 10   | 15   | 20 |
| Capacity in W      |     |     |     |     |     |       | 370  | 449  | 550  | 628  | 673  | 818  | 986  | 1065 | 1176 | 1389 |    |
| Power cons. in W   |     |     |     |     |     |       | 290  | 321  | 354  | 377  | 388  | 423  | 456  | 469  | 485  | 509  |    |
| Current cons. in A |     |     |     |     |     |       | 1.91 | 1.99 | 2.10 | 2.19 | 2.23 | 2.37 | 2.51 | 2.56 | 2.62 | 2.70 |    |
| COP in W/W         |     |     |     |     |     |       | 1.27 | 1.40 | 1.56 | 1.67 | 1.73 | 1.94 | 2.16 | 2.27 | 2.42 | 2.73 |    |

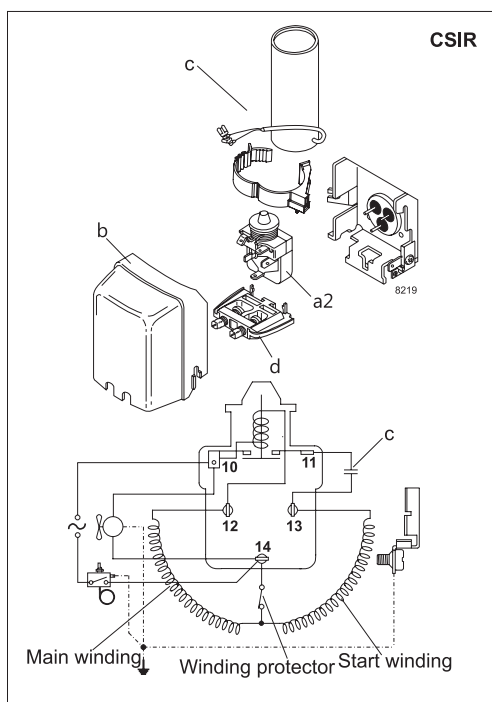

| Accessories for           | FR6DL                   | Figure      | Code number | Test conditions  | EN 12900/CECOMAF | ASHRAE LBP* |                      |  |             |                          |          |          |                          |          |          |                       |          |          |
|---------------------------|-------------------------|-------------|-------------|--|------------------|-------------|----------------------|--|-------------|--------------------------|----------|----------|--------------------------|----------|----------|-----------------------|----------|----------|
| PTC starting device       | 6.3 mm spade connectors | a1          | —           | Condensing temperature   | 45°C             | 45°C        |                      |  |             |                          |          |          |                          |          |          |                       |          |          |
|                           | 4.8 mm spade connectors |             | —           | Ambient temperature  | 32°C             | 32°C        |                      |  |             |                          |          |          |                          |          |          |                       |          |          |
| Starting relay            | 6.3 mm spade connectors | a2          | 117U6010    | Suction gas temperature  | 32°C             | 32°C        |                      |  |             |                          |          |          |                          |          |          |                       |          |          |
| Cover                     |                         | b           | 103N2010    | Liquid temperature   | no subcooling    | 32°C        |                      |  |             |                          |          |          |                          |          |          |                       |          |          |
| Start. capacitor 80 µF    | 6.3 mm spade connectors | c           | 117U5015    | <table><tr><th colspan="2">Mounting accessories</th><th>Code number</th></tr><tr><td>Bolt joint for one comp.</td><td>Ø: 16 mm</td><td>118-1917</td></tr><tr><td>Bolt joint in quantities</td><td>Ø: 16 mm</td><td>118-1918</td></tr><tr><td>Snap-on in quantities</td><td>Ø: 16 mm</td><td>118-1919</td></tr></table> |                  |             | Mounting accessories |  | Code number | Bolt joint for one comp. | Ø: 16 mm | 118-1917 | Bolt joint in quantities | Ø: 16 mm | 118-1918 | Snap-on in quantities | Ø: 16 mm | 118-1919 |
| Mounting accessories      |                         | Code number |             |  |                  |             |                      |  |             |                          |          |          |                          |          |          |                       |          |          |
| Bolt joint for one comp.  | Ø: 16 mm                | 118-1917    |             |  |                  |             |                      |  |             |                          |          |          |                          |          |          |                       |          |          |
| Bolt joint in quantities  | Ø: 16 mm                | 118-1918    |             |  |                  |             |                      |  |             |                          |          |          |                          |          |          |                       |          |          |
| Snap-on in quantities     | Ø: 16 mm                | 118-1919    |             |  |                  |             |                      |  |             |                          |          |          |                          |          |          |                       |          |          |
| Cord relief               |                         | d           | 103N1010    |  |                  |             |                      |  |             |                          |          |          |                          |          |          |                       |          |          |
| Protection screen for PTC |                         | g           | —           |  |                  |             |                      |  |             |                          |          |          |                          |          |          |                       |          |          |

Secop accepts no responsibility for possible errors in catalogs, brochures, and other printed material. Secop reserves the right to alter its products without notice. This also applies to products already on order provided that such alterations can be made without consequential changes being necessary to specifications already agreed. All trademarks in this material are the property of the respective companies. Secop and the Secop logotype are trademarks of Secop GmbH. All rights reserved. [www.secop.com](http://www.secop.com)