

Model

Designation	NLU10KK.1	220-240V/50Hz 1~	Sales code:	105H6193
-------------	------------------	------------------	-------------	-----------------

Compressor design

Oil type	Mineral	Refrigerant(s)	R600a
Oil viscosity	4,6cST	Displacement	10,09cm ³ / 0,62cu.in
Oil quantity	264cm ³ / 8,9fl.oz	Compressors on pallet	80
Refr. charge - tech. limit	150g / 5,3oz		
Free gas volume comp.	2360cm ³ / 79,8fl.oz		
Weight	12,1kg / 26,7lbs		
Motor protection	1# internal		
Winding resistance main	19,39Ω (at 25°C)		
Winding resistance aux	22,46Ω (at 25°C)		
Max. winding temp.	105°C / 221°F		
Max. discharge temp.	130°C / 266°F		



General - Configurations with NLU10KK.1

	Conf. 1
Motorconfiguration	RSCR
Power supply (nominal)	220-240V/50Hz
Number of phases	1
Voltage range	198-254V
Approvals	VDE, CB
Starting torque	LST
Note	- / -

Applications with NLU10KK.1

	Conf. 1
Refrigerant	R600a
Application	LBP
System cooling	static
Hot gas defrost	- / -
Long interval pull down	- / -

Electrical data - Configurations with NLU10KK.1

	Conf. 1
Starting device type	PTC
Run capacitor	2,5μF
Start capacitor	- / -
LRA (locked rotor amps / 4s)	3,1A
RLA (rated load amps / 1s)	0,5A
Cut in current	6A

Model

Designation

NLU10KK.1

220-240V/50Hz 1~

Sales code:

105H6193

Compressor dimensions

Housing	A Height	203mm / 7,99in
	B Height	197mm / 7,76in
	C Length shell	205mm / 8,07in
	D Length w. cover	254mm / 10in
	E Width	166mm / 6,54in

Connectors		Suction	Discharge	Process
		X	Y	Z
Diameter	[mm]	øi 6,11-6,29	øi 5,12-5,22	øi 6,11-6,29
	(i:inside, o:outside) [in]	øi 0,24-0,25	øi 0,2-0,21	øi 0,24-0,25
Material		copper	copper	copper
Horizontal angle	±2°	0°	0°	0°
Vertical angle	±2°	15°	21°	155°
Position l/h/w	[mm]	133/71/57	91/103/81	-107/94/72
	[in]	5,2/2,8/2,2	3,6/4/3,2	-4,2/3,7/2,8
Straight tube l.	[mm]	12	12	12
	[in]	0,5	0,5	0,5

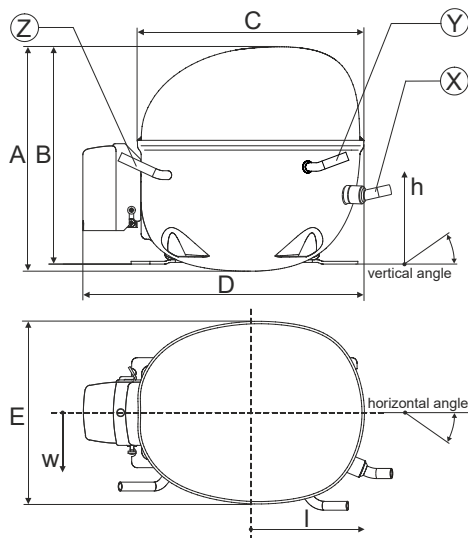

Compressor fixation

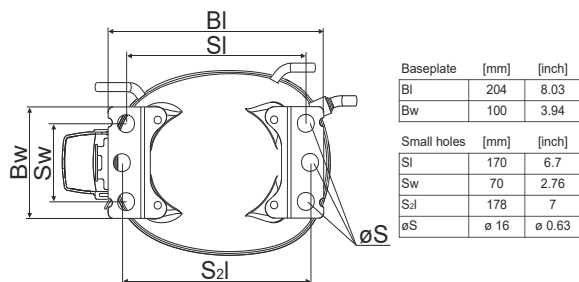

Bolt joint



Snap-on



Mounting accessories

	one comp.	multi pack
Bolt joint M6 ø16mm	118-1917	118-1918
Bolt joint ø1/4" ø16mm	118-1946	
Snap-on ø7,3 ø16mm	118-1947	118-1919

Model

Designation	NLU10KK.1	220-240V/50Hz	Conf. 1	Sales code:	105H6193
-------------	------------------	----------------------	----------------	-------------	-----------------

Configuration

Motorconfiguration	RSCR
Power supply (nominal)	220-240V/50Hz 1~
Refrigerant	R600a
Application	LBP
Voltage range	198-254V
Starting torque	LST
Approvals	VDE CB

Electrical accessories / wiring diagram

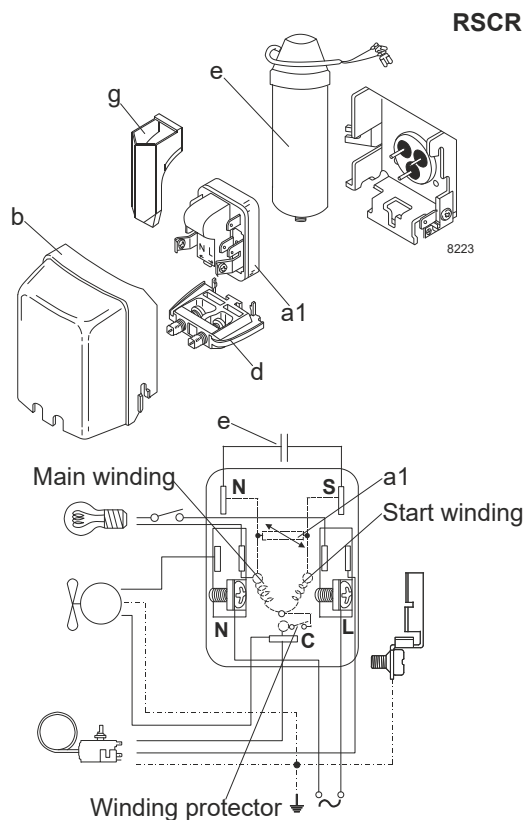

Ambient temperatures / system cooling

Ambient temperature min.:	10°C / 50°F
Ambient temperature max.:	43°C / 110°F

System cooling (n/a: outside limits)			
T ambient	LBP	MBP	HBP
32°C / 90°F	static	n/a	n/a
38°C / 100°F	static	n/a	n/a
43°C / 110°F	static	n/a	n/a

Operation pressure range

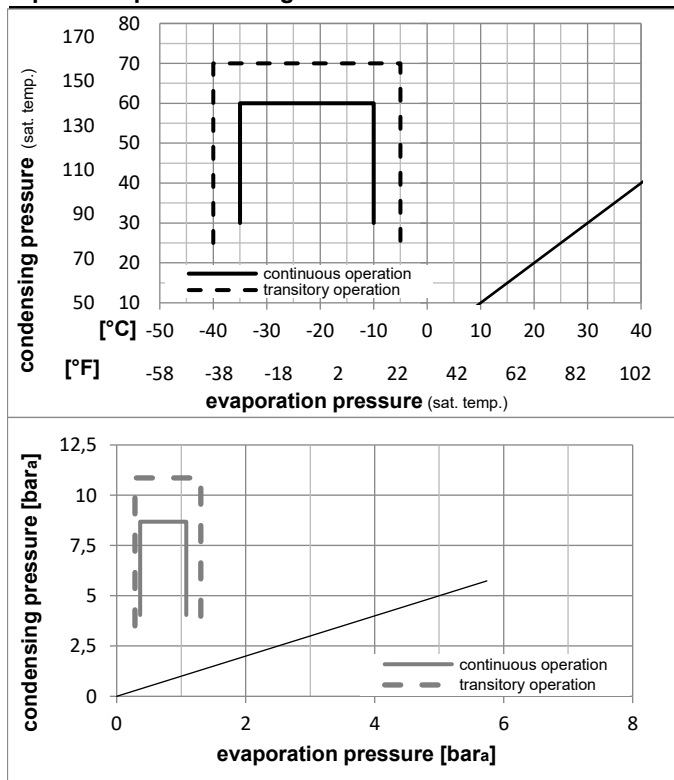

Components

a1	e-PTC starter (220V, 380hm, 4.8mm)	103N0055
e	run capacitor (2.5μF, 4.8mm)	117-7139
b	plastic cover	103N2010
d	cord relief	103N1010
	bracket for run capacitor	117-0300
	screw M4x8mm	117-0301

Alternative components

a1	PTC starter (220V, 250hm, 4.8mm)	103N0021
e	run capacitor (2.5μF, 4.8mm)	117-7139
b	plastic cover	103N2011
d	cord relief	103N1010
g	protection screen for PTC	103N0476
	bracket for run capacitor	117-0300

Model

Designation **NLU10KK.1 220-240V/50Hz** Conf. 1 Sales code: **105H6193**

Optimization + standard conditions

R600a, 220V/50Hz, RSCR, static, VDE, CB

	pe	pc	RGT	Tliq	Cooling capacity		COP	EER		P1	I	Ref. mass flow	
	[°C]	[°C]	[°C]	[°C]	[W]	[Btu/h]	[W/W]	[Btu/Wh]	[kcal/Wh]	[W]	[A]	[kg/h]	
Evaporating pressure (saturation temperature)	-23	54	32	32	175,7	600	1,98	6,75	1,70	88,8	0,40	1,89	ASHRAE LBP
Condensing pressure (saturation temperature)	-10	130	90	90									
Return gas temp.													
Liquid temp.													
	[°F]	[°F]	[°F]	[°F]									
	-25	55	32	55	131,5	449	1,55	5,30	1,34	84,7	0,38	1,72	cecomaf LBP
	-13	131	90	131									
	[°C]	[°C]	[°C]	[°C]									
	-35	40	20	40	91,9	314	1,58	5,39	1,36	58,3	0,26	1,12	EN12900 LBP
	-31	104	68	104									
	[°F]	[°F]	[°F]	[°F]									
	-23	49	4,4	49	143,8	491	1,67	5,71	1,44	86,1	0,39	2,10	ARI540 LBP
	-10	120	40	120									
	[°F]	[°F]	[°F]	[°F]									
	-23	41	32	32	190,3	650	2,33	7,96	2,01	81,7	0,37	2,04	AHAM LBP
	-10	105	90	90									
	[°F]	[°F]	[°F]	[°F]									
	-35	45	32	45	87,2	298	1,48	5,06	1,28	58,9	0,26	1,04	opt
	-31	113	90	113									
	[°F]	[°F]	[°F]	[°F]									

Performance tables

R600a, 220V/50Hz, RSCR, static, VDE, CB

	pe	Cooling capacity			COP	EER	P1	I	m		
	[°C]	[°F]	[W]	[Btu/h]	[kcal/h]	[W/W]	[Btu/Wh]	[kcal/Wh]	[W]	[A]	[kg/h]
[°C / °F]	-35	-31	87,2	298	75,1	1,48	5,06	1,28	58,9	0,26	1,04
cond. pressure	-30	-22	117,6	401	101,2	1,69	5,78	1,46	69,5	0,31	1,40
pc= 45/113	-25	-13	154,1	526	132,6	1,92	6,55	1,65	80,3	0,36	1,83
return gas temp.	-23	-10	168,2	574	144,7	2,00	6,83	1,72	84,1	0,38	2,00
RGT= 32/90	-20	-4	197,9	676	170,3	2,16	7,37	1,86	91,7	0,41	2,36
liquid temp	-15	5	249,8	853	215,0	2,41	8,21	2,07	103,8	0,47	2,98
Tliq= 45/113	-10	14	310,7	1061	267,4	2,65	9,06	2,28	117,1	0,53	3,72
[°C / °F]	-35	-31	70,5	241	60,7	1,21	4,12	1,04	58,4	0,26	0,92
cond. pressure	-30	-22	98,2	335	84,5	1,37	4,69	1,18	71,6	0,32	1,28
pc= 55/131	-25	-13	131,5	449	113,2	1,55	5,30	1,34	84,7	0,38	1,72
return gas temp	-23	-10	144,2	493	124,1	1,62	5,52	1,39	89,2	0,40	1,88
RGT= 32/90	-20	-4	171,3	585	147,4	1,75	5,97	1,50	98,1	0,44	2,24
liquid temp	-15	5	218,5	746	188,1	1,95	6,66	1,68	112,0	0,50	2,86
Tliq= 55/131	-10	14	274,1	936	235,9	2,16	7,38	1,86	126,8	0,57	3,60