

## Single Pack NF7MLX 220-240V 50Hz / 208-230V 60Hz CSIR

Single pack code number: **195B4438**

| Position | Title   | Code     | Amount |
|----------|---|----------|--------|
| 1        | Compressor NF7MLX                             | 105F3721 | 1      |
| 2        | Starting relay (overload protector MRP56EN-6) | 117U4139 | 1      |
| 3        | Starting capacitor (125µF 220V, 6.3mm)        | 117U5018 | 1      |
| 4        | Cord relief                                   | 117U0349 | 1      |
| 5        | Cover   | 117U1021 | 1      |
| 6        | Bolt joint for one compressor   M6   ø16mm    | 118-1917 | 1      |

**Secop GmbH** • Lise-Meitner-Straße 29 • 24941 Flensburg, Germany • Tel: +49 461 4941 0 • [www.secop.com](http://www.secop.com)

Secop accepts no responsibility for possible errors in catalogs, brochures, and other printed material. Secop reserves the right to alter its products without notice. This also applies to products already on order provided that such alterations can be made without subsequent changes being necessary to specifications already agreed. All trademarks in this material are the property of the respective companies. Secop and the Secop logotype are trademarks of Secop GmbH. All rights reserved.

## NF7MLX MBP Compressor R404A/R507 220-240V 50Hz & 208-230V 60Hz

### General

|                       |               |
|-----------------------|---------------|
| Code number           | 105F3721      |
| Approvals             | EN 60335-2-34 |
| Compressors on pallet | 80            |

### Application

| Application                                    | MBP |           |              |  |
|--|-----|-----------|--------------|--|
| Frequency                                      | Hz  | 50        | 60           |  |
| Evaporating temperature                        | °C  | -15 to 10 | -23.3 to 7.2 |  |
| Voltage range                                  | V   | 187 - 254 | 187 - 254    |  |
| Max. condensing temperature continuous (short) | °C  | 55 (60)   | 55 (60)      |  |
| Max. winding temperature continuous (short)    | °C  | 125 (135) | 125 (135)    |  |

### Cooling requirements

|   |    |     |                |     |     |                |     |
|---|----|-----|----------------|-----|-----|----------------|-----|
| Frequency   | Hz | 50  |                |     | 60  |                |     |
| Application   |    | LBP | MBP            | HBP | LBP | MBP            | HBP |
| 32°C  |    | —   | F <sub>2</sub> | —   | —   | F <sub>2</sub> | —   |
| 38°C  |    | —   | F <sub>2</sub> | —   | —   | F <sub>2</sub> | —   |
| 43°C  |    | —   | F <sub>2</sub> | —   | —   | F <sub>2</sub> | —   |
| Remarks on application: 220V 50Hz nominal below -10°C evaporating temperature |    |     |                |     |     |                |     |

### Motor

|   |      |      |      |
|---|------|------|------|
| Motor type                                | CSIR |      |      |
| LRA (rated after 4 sec. UL984), HST   LST | A    | 21.0 | —    |
| Cut in Current, HST   LST                 | A    | 21.0 | —    |
| Resistance, main   start winding (25°C)   | Ω    | 4.5  | 12.8 |

### Design

|                                     |                 |                   |
|-------------------------------------|-----------------|-------------------|
| Displacement                        | cm <sup>3</sup> | 7.27              |
| Oil quantity (type)                 | cm <sup>3</sup> | 300 (polyolester) |
| Maximum refrigerant charge          | g               | 400               |
| Free gas volume in compressor       | cm <sup>3</sup> | 2310              |
| Weight without electrical equipment | kg              | 10.5              |

### Dimensions

|                      |                          |                      |           |
|----------------------|--------------------------|----------------------|-----------|
| Height               | mm                       | A                    | 203       |
|                      |                          | B                    | 197       |
|                      |                          | B1                   | —         |
|                      |                          | B2                   | —         |
| Suction connector    | location/I.D. mm   angle | C                    | 8.2   15° |
|                      | material   comment       | Copper   Rubber plug |           |
| Process connector    | location/I.D. mm   angle | D                    | 6.2   25° |
|                      | material   comment       | Copper   Rubber plug |           |
| Discharge connector  | location/I.D. mm   angle | E                    | 6.2   35° |
|                      | material   comment       | Copper   Rubber plug |           |
| Oil cooler connector | location/I.D. mm   angle | F                    | —         |
|                      | material   comment       | —                    |           |
| Connector tolerance  | I.D. mm                  | ±0.09                |           |
| Remarks:             |                          |                      |           |

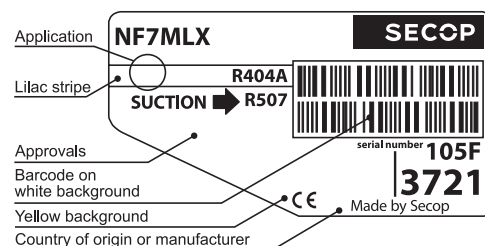

- S = Static cooling normally sufficient
- O = Oil cooling
- F<sub>1</sub> = Fan cooling 1.5 m/s (compressor compartment temperature equal to ambient temperature)
- F<sub>2</sub> = Fan cooling 3.0 m/s necessary
- SG = Suction gas cooling normally sufficient
- = not applicable in this area

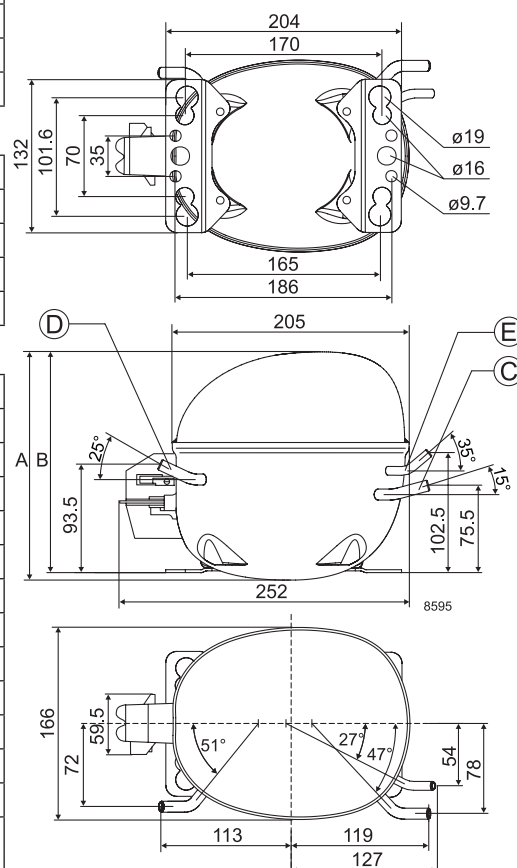

**ASHRAE MBP**230V, 60Hz, fan cooling F<sub>2</sub>

|                    |     |     |     |     |     |       |      |      |      |      |      |      |      |      |    |    |    |
|--------------------|-----|-----|-----|-----|-----|-------|------|------|------|------|------|------|------|------|----|----|----|
| Evap. temp. in °C  | -45 | -40 | -35 | -30 | -25 | -23.3 | -20  | -15  | -10  | -6.7 | -5   | 0    | 5    | 7.2  | 10 | 15 | 20 |
| Capacity in W      |     |     |     |     |     | 363   | 438  | 563  | 708  | 815  | 874  | 1065 | 1284 | 1390 |    |    |    |
| Power cons. in W   |     |     |     |     |     | 368   | 398  | 445  | 494  | 529  | 547  | 603  | 663  | 691  |    |    |    |
| Current cons. in A |     |     |     |     |     | 2.38  | 2.51 | 2.70 | 2.89 | 3.02 | 3.09 | 3.29 | 3.50 | 3.59 |    |    |    |
| COP in W/W         |     |     |     |     |     | 0.99  | 1.10 | 1.27 | 1.43 | 1.54 | 1.60 | 1.77 | 1.94 | 2.01 |    |    |    |

**EN 12900 Household (CECOMAF)**230V, 60Hz, fan cooling F<sub>2</sub>

|                    |     |     |     |     |     |       |      |      |      |      |      |      |      |      |    |    |    |
|--------------------|-----|-----|-----|-----|-----|-------|------|------|------|------|------|------|------|------|----|----|----|
| Evap. temp. in °C  | -45 | -40 | -35 | -30 | -25 | -23.3 | -20  | -15  | -10  | -6.7 | -5   | 0    | 5    | 7.2  | 10 | 15 | 20 |
| Capacity in W      |     |     |     |     |     | 413   | 489  | 618  | 768  | 879  | 940  | 1137 | 1362 | 1470 |    |    |    |
| Power cons. in W   |     |     |     |     |     | 358   | 385  | 428  | 473  | 504  | 521  | 573  | 629  | 656  |    |    |    |
| Current cons. in A |     |     |     |     |     | 2.37  | 2.47 | 2.62 | 2.78 | 2.89 | 2.94 | 3.11 | 3.28 | 3.35 |    |    |    |
| COP in W/W         |     |     |     |     |     | 1.15  | 1.27 | 1.45 | 1.62 | 1.74 | 1.80 | 1.98 | 2.16 | 2.24 |    |    |    |

**ASHRAE MBP**220V, 50Hz, fan cooling F<sub>2</sub>

|                    |     |     |     |     |     |       |     |      |      |      |      |      |      |      |      |    |    |
|--------------------|-----|-----|-----|-----|-----|-------|-----|------|------|------|------|------|------|------|------|----|----|
| Evap. temp. in °C  | -45 | -40 | -35 | -30 | -25 | -23.3 | -20 | -15  | -10  | -6.7 | -5   | 0    | 5    | 7.2  | 10   | 15 | 20 |
| Capacity in W      |     |     |     |     |     |       |     | 466  | 585  | 673  | 722  | 880  | 1061 | 1148 | 1268 |    |    |
| Power cons. in W   |     |     |     |     |     |       |     | 397  | 434  | 458  | 470  | 504  | 536  | 549  | 565  |    |    |
| Current cons. in A |     |     |     |     |     |       |     | 3.06 | 3.17 | 3.24 | 3.28 | 3.40 | 3.52 | 3.57 | 3.64 |    |    |
| COP in W/W         |     |     |     |     |     |       |     | 1.17 | 1.35 | 1.47 | 1.54 | 1.75 | 3.52 | 2.09 | 2.24 |    |    |

**EN 12900 Household (CECOMAF)**220V, 50Hz, fan cooling F<sub>2</sub>

|                    |     |     |     |     |     |       |     |      |      |      |      |      |      |      |      |    |    |
|--------------------|-----|-----|-----|-----|-----|-------|-----|------|------|------|------|------|------|------|------|----|----|
| Evap. temp. in °C  | -45 | -40 | -35 | -30 | -25 | -23.3 | -20 | -15  | -10  | -6.7 | -5   | 0    | 5    | 7.2  | 10   | 15 | 20 |
| Capacity in W      |     |     |     |     |     |       |     | 511  | 635  | 726  | 777  | 940  | 1125 | 1215 | 1336 |    |    |
| Power cons. in W   |     |     |     |     |     |       |     | 374  | 406  | 425  | 435  | 463  | 488  | 498  | 511  |    |    |
| Current cons. in A |     |     |     |     |     |       |     | 3.01 | 3.10 | 3.17 | 3.20 | 3.29 | 3.39 | 3.43 | 3.49 |    |    |
| COP in W/W         |     |     |     |     |     |       |     | 1.37 | 1.57 | 1.71 | 1.78 | 2.03 | 2.31 | 2.44 | 2.62 |    |    |

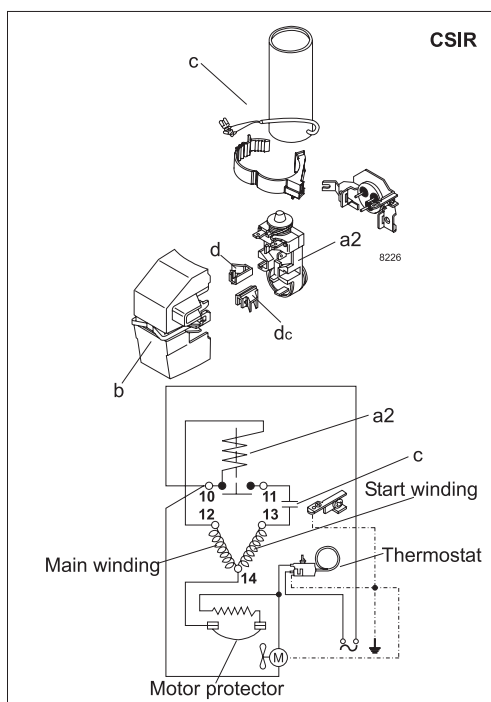

| Accessories for NF7MLX    |                         | Figure      | Code number | Test conditions  | EN 12900/CECOMAF | ASHRAE MBP |                      |  |             |                          |          |          |                          |          |          |                       |          |          |
|---------------------------|-------------------------|-------------|-------------|--|------------------|------------|----------------------|--|-------------|--------------------------|----------|----------|--------------------------|----------|----------|-----------------------|----------|----------|
| Starting relay            | 6.3 mm spade connectors | a1          | 117U4139    | Condensing temperature   | 43.3°C           | 54.4°C     |                      |  |             |                          |          |          |                          |          |          |                       |          |          |
| (protector incl.)         |                         |             | MRP56EN-6   | Ambient temperature  | 32°C             | 35°C       |                      |  |             |                          |          |          |                          |          |          |                       |          |          |
| Protector 3/4 in.         | Texas Instruments       |             |             | Suction gas temperature  | 32°C             | 35°C       |                      |  |             |                          |          |          |                          |          |          |                       |          |          |
| Cover (UL approved)       |                         | b           | 117U1021    | Liquid temperature   | no subcooling    | 46.1°C     |                      |  |             |                          |          |          |                          |          |          |                       |          |          |
| Start. capacitor 125 µF   | 6.3 mm spade connectors | c           | 117U5018    | <table><tr><th colspan="2">Mounting accessories</th><th>Code number</th></tr><tr><td>Bolt joint for one comp.</td><td>Ø: 16 mm</td><td>118-1917</td></tr><tr><td>Bolt joint in quantities</td><td>Ø: 16 mm</td><td>118-1918</td></tr><tr><td>Snap-on in quantities</td><td>Ø: 16 mm</td><td>118-1919</td></tr></table> |                  |            | Mounting accessories |  | Code number | Bolt joint for one comp. | Ø: 16 mm | 118-1917 | Bolt joint in quantities | Ø: 16 mm | 118-1918 | Snap-on in quantities | Ø: 16 mm | 118-1919 |
| Mounting accessories      |                         | Code number |             |  |                  |            |                      |  |             |                          |          |          |                          |          |          |                       |          |          |
| Bolt joint for one comp.  | Ø: 16 mm                | 118-1917    |             |  |                  |            |                      |  |             |                          |          |          |                          |          |          |                       |          |          |
| Bolt joint in quantities  | Ø: 16 mm                | 118-1918    |             |  |                  |            |                      |  |             |                          |          |          |                          |          |          |                       |          |          |
| Snap-on in quantities     | Ø: 16 mm                | 118-1919    |             |  |                  |            |                      |  |             |                          |          |          |                          |          |          |                       |          |          |
| Cord relief               |                         | d           | 117U0349    |  |                  |            |                      |  |             |                          |          |          |                          |          |          |                       |          |          |
| Cord relief for capacitor |                         | dc          | 117U0349    |  |                  |            |                      |  |             |                          |          |          |                          |          |          |                       |          |          |

Secop accepts no responsibility for possible errors in catalogs, brochures, and other printed material. Secop reserves the right to alter its products without notice. This also applies to products already on order provided that such alterations can be made without subsequential changes being necessary to specifications already agreed. All trademarks in this material are the property of the respective companies. Secop and the Secop logotype are trademarks of Secop GmbH. All rights reserved. [www.secop.com](http://www.secop.com)

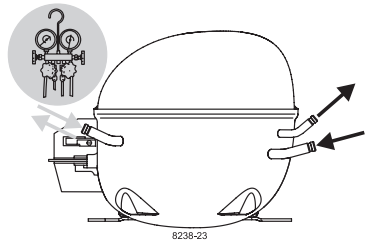

# NF Compressors

**SECOP**

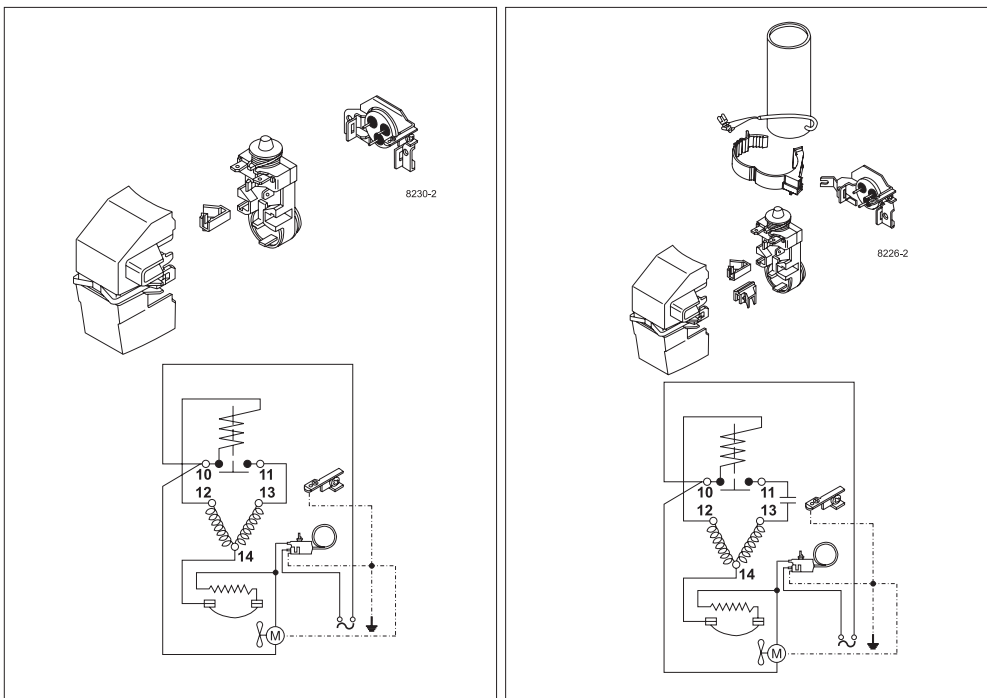

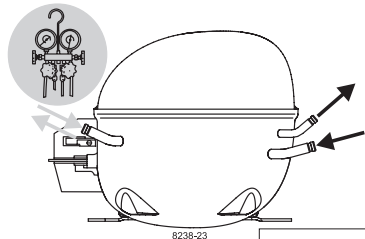

# NF Compressors

**SECOP**

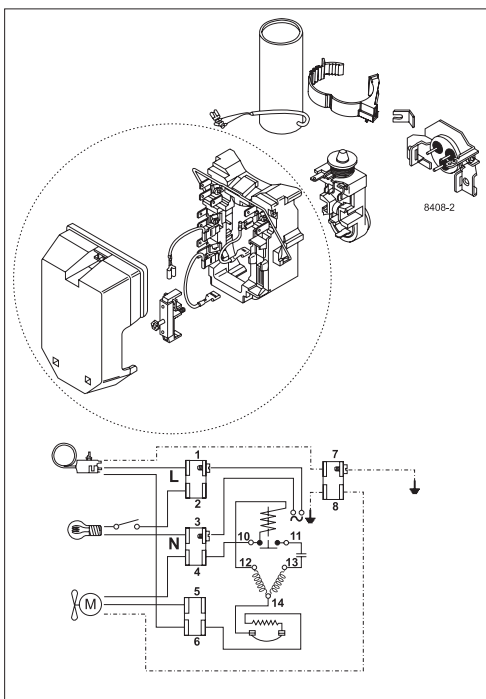
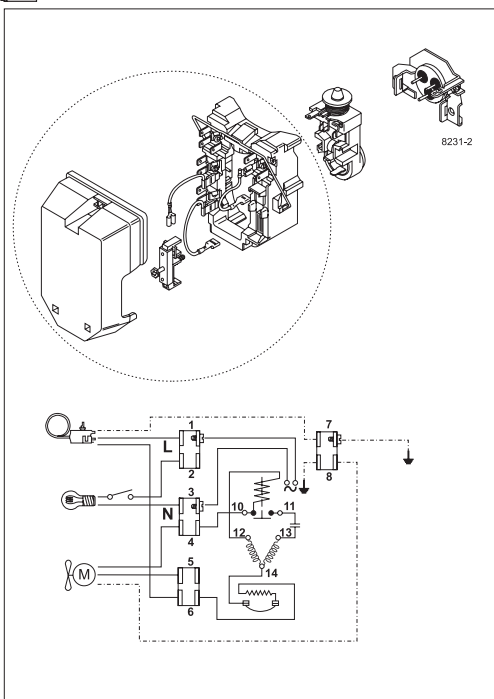

Secop accepts no responsibility for possible errors in catalogs, brochures, and other printed material. Secop reserves the right to alter its products without notice. This also applies to products already on order provided that such alterations can be made without subsequential changes being necessary to specifications already agreed. All trademarks in this material are the property of the respective companies. Secop and the Secop logotype are trademarks of Secop GmbH. All rights reserved. [www.secop.com](http://www.secop.com)